

## DIN 94 Split Cotter Pins

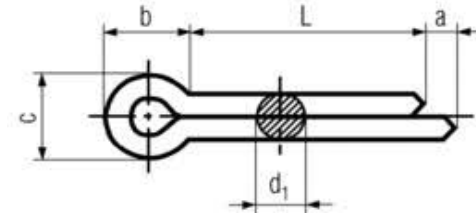

DIN 94 Split Cotter Pins												
Pin Diameter-d1	1	1.2	1.6	2	2.5	3.2	4	5	6.3	8	10	13
d-Min	0.8	0.9	1.7	1.70	2.1	2.7	3.5	4.4	5.7	7.3	9.3	12.1
d-Max	0.9	1	1.4	1.8	2.3	2.9	3.7	4.6	5.9	7.5	9.5	12.4
a-Max	1.6	2.5	2.5	2.5	2.5	3.2	4	4	4	4	6.3	6.3
b	3	3	3.2	4	5	6.4	8	10	12.6	16	20	26
c-Max	1.8	2.0	2.8	3.6	4.6	5.8	7.4	9.2	11.8	15	19	24.8

*Available Lengths Upon Request*

Material
Mild Steel Self Colour
Stainless Steel A2 and A4

INFORMATION AND DRAWINGS PROVIDED ARE FOR REFERENCE ONLY